

TYPE: R - Residential (Under 10 Acres) (Page 2) As Of 11/14/2024 08:44:56

Loc: 519 N 10TH ST Neighborhood: 701 - 72 Corridor, Ward 7

Des: 519 N 10TH ST Zoning:.....

LEBANON PA 17046-3419 Township:.....: 07 - LEBANON CITY, WARD 7

ID#	TYPE	DESC.	SIZE	STY	SQFT	AGE/COND	PRICE	FACTOR	VALUE
001	DECK	WOOD	8 x 10 x 1 =		80	2007	2.50		200

Plot Plan:
No Plot Plan Entered

====Road Frontage====

LOT SIZE: 16 actual frontage TOTAL OUTBUILDING VALUE: 200

Frontage: 16 Depth: 119 Total Lot SqFt 1904

FF?:

Type: Int Perc:

FAIR MARKET LAND VALUE

ACRES	BASERATE	INDX	SLOPE	PROD	\$/ACRE	VALUE
Lot SqFt	1904				3.72	7094
Baseacre						7094
Open 1						
Open 2						
Wooded						
DEEDED	.04					7100
						Adjustments 0
						FAIR MARKET LAND TOTAL

AGRICULTURAL USE LAND VALUE

BASERATE	PRODUCTIVITY	\$/ACRE	VALUE
----------	--------------	---------	-------

BASEACRE

Open 1

Open 2

Wooded

(acres Ineligible) Adjustments 0

DEEDED .04 CLEAN AND GREEN LAND TOTAL

C&G Enrolled? NO Ag Sec Area: N Avg Slope: %

General Remarks:
PAGE BLANK

07-2336629-372111-0000

BARRETT, MICHAEL A

PROPERTY RECORD CARD: LEBANON COUNTY

SPEC ID: CTL: 38006062

519 N 10TH ST

PA 17046-3419

Fair Market Land - 7100

Clean & Green: NO

SCHOOL: 4 Nbhnd: 701

LEBANON

Old Map #: 07-582A.-043.-0000

Bldg - 33200

T -

Part Interest of

RESIDENTIAL INFORMATION:

Total - 40300

A -

Building Descript TAN VINYL, WHITE TRIM

PROPERTY TYPE..... R (101)

Living A. 1302

SQFT

Stories Group.... Z

PROPERTTY TYPE..... R (101)

Year Built..(est). 1930

Open/LA.. 0

EPrch 0

Exterior Walls... Vinyl

Remodeled.....

Effective Age..... 1974 (2)

Unfin Liv 0

Porch 158

Neighborhood Type RES

Condition (I vs E) AV (S)

Lower LA. 0

Garag 0

Heating Dist.... Hot Water

QUALITY GRADE..... B+0 (105)

Fin Bsmt. 0

Deck. 155

Heating Source... Oil

Perm Stair Attic... UNF

Basement. 644

Slab. 0

Total/Bed Rooms.. 7 / 3

FINAL RESIDENTIAL VALUE... = 32991

Gar Bsmt. 0

Obldg 0

Full/Half Baths.. 1 / 0

Basement..... 100 %

Fireplace Count.. 0

OUTBUILDING VALUE..... = 200

Central A/C..... NO

Other Residentials () =

Lot Type: Interior

Other Commercials () =

Terrain : Level

Adjustments..... =

Sewer : Public

TOTAL IMPROVEMENT VALUE... = 33200

Water : Public

Mobile Home Class: 33200

Road : Paved

AgScrtv: N Sdewlk: Y

GasAval: GWS SpView: N

Historic: N WtrFnt: N

RailAval: N TreeCv: 0

Limiting Factors:

Size: X Addn:

DATE FM LAND FM BLDG FM TOTAL -- ST CG LAND CG BLDG CG TOTAL

DATE	FM LAND	FM BLDG	FM TOTAL	-- ST	CG LAND	CG BLDG	CG TOTAL
11/17/2012	7100	33200	40300				
06/29/2012	7100	33200	40300				
06/14/2012	500	5700	6200				
04/02/2004	500	5700	6200				

Instrument	Date	Price
Multiple:		
00203-0779	12/19/1983	19000
00177-0313	04/24/1980	16000
00175-0962	02/15/1980	
Q-08-0293	06/15/1948	
Q-07-0127	05/27/1941	



Lebanon County Tax Assessment Office



- Tax Parcels
- Roads
- Buildings
- Buildings Under Construction
- Subdivision Lot
- Tract
- Municipal Boundary
- County Boundary

1 Inch = 40 feet

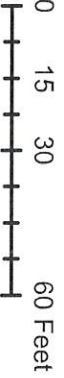

Disclaimer:
 Tax maps show the approximate boundaries of taxable and non-taxable property. The property boundaries depicted should not be interpreted as the legal boundary description. The legal boundary description can be obtained from the property's deed.



Tax Maps Compiled from 1997 Aerial Photography
 Map Projection - PA State Plane Coordinate System
 South Zone, NAD83, Coordinates in Feet



Tract #1 of	Deed Book	Date Transferred	Date Recorded	OWNER	ACRES		Cont'd. section	REMARKS
					Sealed Proportion	Unsealed		
79127			2 Apr 41	STRICKLER, Louise K. & Alfred D.	16'	119'		205 High Street, Lebanon, Pa.
89293		15 Jun 48	15 Jun 48	PEIFFER, Clarence B. & Gertrude A.	16'	119'	\$1,000	
175-962		15 Feb 80	15 Feb 80	PEIFFER, William K. & interest	16'	119'	AWARD OF	2130 Brentwood Place Augusta Ga
175-962		15 Feb 80	15 Feb 80	PEIFFER, Richard C. & interest	16'	119'	REAL ESTATE	1130 Kochsanderfer Rd Lebanon Pa
177-313		24 Apr 80	24 Apr 80	EGGERS, David M. BINKLEY, Shelley M.	16'	119'	\$16,000	519 N 10th St Lebanon Pa. 17042
203-779		19 Dec 83	19 Dec 83	BARRETT, Michael A.	16'	119'	\$19,000	519 N 10th St Lebanon Pa. 17042

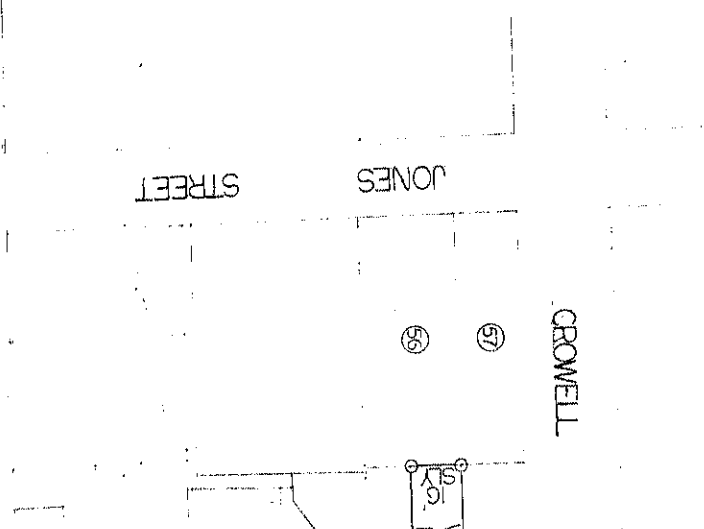

17-401
VWP
18 NOV

ASSESSED VALUATION			
Year	Land	Improvements	Total
1942	400	1800	2200
1949	400	2100	2500
1950	400	2400	2800
1980	150	2750	2800
1972	230	2850	3100

IMPROVEMENTS